

**PERMIT**

**CITY OF NAPOLEON - BUILDING DEPARTMENT**

255 West Riverview Avenue, Napoleon, Ohio 43545 - 419-592-4010

Permit No. 01067 Issued July 26, 1985  
date

Job Location 1600 Oakwood  
address

Lot \_\_\_\_\_  
sub-div or legal discript

Issued By Richard G. Hayman  
building official

Owner Eugene & Barbara Hogrefe 592-2831  
name tel.

Address 607 E. Riverview

Agent Ron Zachrich 762-5277  
builder-eng.-etc. tel.

Address Rt. 2, Napoleon

Description of Use New Single Family /with  
attached garage

Residential Single  
no. dwelling units

Commercial \_\_\_\_\_ Industrial \_\_\_\_\_

New \_\_\_\_\_ Add'n. \_\_\_\_\_ Alter \_\_\_\_\_ Remodel \_\_\_\_\_

Mixed Occupancy \_\_\_\_\_

Change of Occupancy \_\_\_\_\_

Estimated Cost \$ 82,000 <sup>00</sup>/<sub>100</sub>

FEE	BASE	PLUS	TOTAL
BUILDING			132.00
ELECTRICAL	5.00	40.00	45.00
PLUMBING	3.00	12.00	15.00
MECHANICAL	6.00	<del>4.75</del> 2.00	<del>10.75</del> 8.00
DEMOLITION			
ZONING			
SIGN			
WATER TAP	300.00		300.00
SEWER TAP	<del>60.00</del>		<del>60.00</del>
TEMP. ELECT.	10.00		10.00
ADDITIONAL PLAN REVIEW	Struct. _____ hrs Elect. _____ hrs		
TOTAL FEES		511.00	561.00
LESS MIN. FEES PAID			-0-
BALANCE DUE		511.00	561.00

**ZONING INFORMATION**

district	lot dimensions	area	front yd	side yds	rear yd
B	546 X 406	221,676			
max hgt	no pkg spaces	no ldg spaces	max cover	petition or appeal req'd	date appr

**WORK INFORMATION:**

Size: Length 73 ft. Width 36 ft. Stories Split Ground Floor Area \_\_\_\_\_

Height \_\_\_\_\_ Building Volume (for demo. permit) \_\_\_\_\_ cu. ft.

Electrical: \_\_\_\_\_  
brief description

Plumbing: \_\_\_\_\_  
brief description

Mechanical: \_\_\_\_\_  
brief description

Sign: \_\_\_\_\_ Dimensions \_\_\_\_\_ Sign Area \_\_\_\_\_  
type

Additional Information: \_\_\_\_\_

**PAID**  
 JUL 30 1985  
 CITY OF NAPOLEON

Date \_\_\_\_\_ Applicant Signature Ron Zachrich  
owner-agent

# INSPECTION RECORD

	UNDERGROUND			ROUGH-IN						FINAL		
	Type	Date	By	Type	Date	By	Type	Date	By	Type	Date	By
<b>PLUMBING</b>	Building Drains			Drainage, Waste & Vent Piping	10/1/85	RJA	Indirect Waste			Drainage, Waste & Vent Piping	10/1/85	RJA
	Water Piping									Backflow Prevention		
	Building Sewer	10/1/85	RJA	Water Piping			Condensate Lines			Water Heater		
	Water Line	3/85	RJA									
	Sewer Connection									FINAL APPROVAL		
<b>MECHANICAL</b>	Refrigerant Piping			Refrigerant Piping			Chimney(s)			Grease Exhaust System		
				Duct Furnace(s)			Fire Dampers			Air Cond. Unit(s)		
	Ducts/Plenums			Ducts/Plenums			<input type="checkbox"/> Radiant Htr(s) <input type="checkbox"/> Unit Htr(s)			Refrigeration Equipment		
				Duct Insulation			Pool Heater			Furnace(s)		
				Combustion Products Vents			Ventilation <input type="checkbox"/> Supply <input type="checkbox"/> Exhst.			FINAL APPROVAL		
<b>ELECTRICAL</b>	Conduits & or Cable			Conduits/Cable			<input type="checkbox"/> Range <input type="checkbox"/> Dryer			Temp Service Temp Lighting		
	Grounding & or Bonding			Rough Wiring	11/10/85	RJA	<input type="checkbox"/> Generator(s) <input type="checkbox"/> Motors			Fixtures Lampholders		
	Floor Ducts Raceways			Service Panel Switchboard	10/1/85	RJA	<input type="checkbox"/> Water Htr <input type="checkbox"/> Welder			Signs		
	Service Conduit			Busways Ducts			<input type="checkbox"/> Heaters <input type="checkbox"/> Heat Cable			Electric Mtr. Clearance	10/1/85	RJA
	Temporary Power Pole			Subpanels			<input type="checkbox"/> Duct Htr(s) <input type="checkbox"/> Furnace(s)			FINAL APPROVAL		
<b>BUILDING</b>	Location, Set-backs, Esmt(s)			Exterior Wall Construction	9/16/85	RJA	Roof Covering Roof Drainage	9/16/85	RJA	Smoke Detector		
	Excavation			Excavation	10/1/85	RJA	Exterior Lath			Demolition (sewer cap)		
	Footings & Reinforcing	9/1/85	RJA				<input type="checkbox"/> Interior Lath <input type="checkbox"/> Wallboard					
	Floor Slab			Interior Wall Construction			Fire Wall(s)			Building or Structure	12/20/85	RJA
	Foundation Walls	9/1/85	RJA	Columns & Supports			Fireplace Chimney					
	Sub-soil Drain			Crawl Space <input type="checkbox"/> Vent <input type="checkbox"/> Access			Attic <input type="checkbox"/> Vent <input type="checkbox"/> Access	12/20/85	RJA			
	Piles			Floor System(s)	9/16/85	RJA				FINAL APPROVAL BLDG. DEPT.		
			Roof System	9/16/85	RJA	Special Insp Reports Rec'd			Certificate of Occupancy Issued			
<b>ADDITIONAL</b>	<b>INSPECTIONS, CORRECTIONS, ETC.</b>						<b>INSPECTIONS, CORRECTIONS, ETC.</b>					
	3/8/84 Basement Botch.						RJA					
	11 Dec 85 REQUIREMENT FOR FURNACE CHIMNEY GAS RANGE & DRYER											

**PERMIT**

**CITY OF NAPOLEON - BUILDING DEPARTMENT**  
 255 West Riverview Avenue, Napoleon, Ohio 43545 - 419-592-4010

Permit No. 010677 Issued July 26, 1985 date  
 Job Location 1600 Oakwood address  
 Lot \_\_\_\_\_ sub-div or legal discript  
 Issued By Richard G. Haymen building official  
 Owner Eugene & Barbara Hogrefe 592-2831 name tel.  
 Address 607 E. Riverview  
 Agent Ron Zachrich 762-5277 builder-eng.-etc. tel.  
 Address Rt. 2, Napoleon  
 Description of Use New Single Family /with attached garage  
 Residential Single no. dwelling units  
 Commercial \_\_\_\_\_ Industrial \_\_\_\_\_  
 New \_\_\_\_\_ Add'n. \_\_\_\_\_ Alter \_\_\_\_\_ Remodel \_\_\_\_\_  
 Mixed Occupancy \_\_\_\_\_  
 Change of Occupancy \_\_\_\_\_  
 Estimated Cost \$ 82,000 <sup>00</sup>/<sub>100</sub>

FEE	BASE	PLUS	TOTAL
BUILDING			132.00
ELECTRICAL	5.00	40.00	45.00
PLUMBING	3.00	12.00	15.00
MECHANICAL	6.00	<del>1.75</del> 2.00	<del>15.75</del> 2.00
DEMOLITION			
ZONING			
SIGN			
WATER TAP	300.00		300.00
SEWER TAP	<del>60.00</del>		<del>60.00</del>
TEMP. ELECT.	10.00		10.00
ADDITIONAL PLAN REVIEW	Struct. _____ hrs	Elect. _____ hrs	
TOTAL FEES.....			511.00 <del>511.00</del>
LESS MIN. FEES PAID			-0-
BALANCE DUE.....			511.00 <del>511.00</del>

**ZONING INFORMATION**

district	lot dimensions	area	front yd	side yds	rear yd
R	546 X 406	221,676			
max hgt	no pkg spaces	no ldg spaces	max cover	petition or appeal req'd	date appr

**WORK INFORMATION:**

Size: Length 73 ft. Width 36 ft. Stories Split Ground Floor Area \_\_\_\_\_  
 Height \_\_\_\_\_ Building Volume (for demo. permit) \_\_\_\_\_ cu. ft.  
 Electrical: \_\_\_\_\_ brief description  
 Plumbing: \_\_\_\_\_ brief description  
 Mechanical: \_\_\_\_\_ brief description  
 Sign: \_\_\_\_\_ Dimensions \_\_\_\_\_ Sign Area \_\_\_\_\_

Additional Information: \_\_\_\_\_  
 Date \_\_\_\_\_ Applicant Signature Ron Zachrich owner-agent

**PAID**  
 JUL 30 1985  
 CITY OF NAPOLEON

PROPERTY

CITY OF SPRINGFIELD - SPRINGFIELD, MASSACHUSETTS

1964

Lot No.	Block No.	Assessor's Name	Area (Sq. Ft.)	Value
1	1	...	...	...
2	1	...	...	...
3	1	...	...	...
4	1	...	...	...
5	1	...	...	...
6	1	...	...	...
7	1	...	...	...
8	1	...	...	...
9	1	...	...	...
10	1	...	...	...
11	1	...	...	...
12	1	...	...	...
13	1	...	...	...
14	1	...	...	...
15	1	...	...	...
16	1	...	...	...
17	1	...	...	...
18	1	...	...	...
19	1	...	...	...
20	1	...	...	...
21	1	...	...	...
22	1	...	...	...
23	1	...	...	...
24	1	...	...	...
25	1	...	...	...
26	1	...	...	...
27	1	...	...	...
28	1	...	...	...
29	1	...	...	...
30	1	...	...	...
31	1	...	...	...
32	1	...	...	...
33	1	...	...	...
34	1	...	...	...
35	1	...	...	...
36	1	...	...	...
37	1	...	...	...
38	1	...	...	...
39	1	...	...	...
40	1	...	...	...
41	1	...	...	...
42	1	...	...	...
43	1	...	...	...
44	1	...	...	...
45	1	...	...	...
46	1	...	...	...
47	1	...	...	...
48	1	...	...	...
49	1	...	...	...
50	1	...	...	...
51	1	...	...	...
52	1	...	...	...
53	1	...	...	...
54	1	...	...	...
55	1	...	...	...
56	1	...	...	...
57	1	...	...	...
58	1	...	...	...
59	1	...	...	...
60	1	...	...	...
61	1	...	...	...
62	1	...	...	...
63	1	...	...	...
64	1	...	...	...
65	1	...	...	...
66	1	...	...	...
67	1	...	...	...
68	1	...	...	...
69	1	...	...	...
70	1	...	...	...
71	1	...	...	...
72	1	...	...	...
73	1	...	...	...
74	1	...	...	...
75	1	...	...	...
76	1	...	...	...
77	1	...	...	...
78	1	...	...	...
79	1	...	...	...
80	1	...	...	...
81	1	...	...	...
82	1	...	...	...
83	1	...	...	...
84	1	...	...	...
85	1	...	...	...
86	1	...	...	...
87	1	...	...	...
88	1	...	...	...
89	1	...	...	...
90	1	...	...	...
91	1	...	...	...
92	1	...	...	...
93	1	...	...	...
94	1	...	...	...
95	1	...	...	...
96	1	...	...	...
97	1	...	...	...
98	1	...	...	...
99	1	...	...	...
100	1	...	...	...

100-100-100  
 100-100-100  
 100-100-100

100-100-100  
 100-100-100  
 100-100-100

SINGLE FAMILY PERMIT FEES

Building Permit		
Valuation <u>82,000</u>	Fee \$	<u>132.00</u>
Electrical Permit		
Minimum - \$5	Fee \$	<u>5.00</u>
No. Outlets-\$1/ea. <u>40</u>	Fee \$	<u>40.00</u>
Temp. Elec. - \$10	Fee \$	<u>10.00</u>
Plumbing Permit		
Minimum - \$3	Fee \$	<u>3.00</u>
No. Traps-\$1/ea. <u>12</u>	Fee \$	<u>12.00</u>
Heating Permit		
Warm Air-Minimum		
9 Runs - \$6	Fee \$	<u>6.00</u>
Extra Runs-75¢/ea. <u>13</u>	Fee \$	<del>9.75</del>
Hot Water		<u>3.00</u>
Minimum per		
boiler fee - \$3	Fee \$	<u>          </u>
Plus 75¢ ea. rad.		
over four	Fee \$	<u>          </u>
Sewer Tap - \$60	Fee \$	<u>60.00</u>
Water Tap - \$300	Fee \$	<u>300.00</u>
Total Fees		<u>\$577.75</u>



CITY OF NAPOLEON  
BUILDING INSPECTION DEPARTMENT  
APPLICATION FOR BUILDING PERMIT  
(Please print or type)

The undersigned hereby makes application for construction, installation, or alteration work as herein specified, agreeing to do all such work in strict accordance with the City of Napoleon's adopted Building Codes.

Location of project 1600 OAKWOOD Cost of project \_\_\_\_\_

Owner's Name Eugene & Barbara Hogrefe Address 424 East 607 E. Riverview

Contractor Ron Zachrich Telephone No. 762-5277

Address Rt. 2 Napoleon

Lot Information: (Not required for siding job)

Lot No. \_\_\_\_\_ Subdivision \_\_\_\_\_

Zoning District B Lot Size 546 ft. X 406 ft. Area 221,676 sq. ft.

Setbacks: Front \_\_\_\_\_ Right Side \_\_\_\_\_ Left Side \_\_\_\_\_ Rear \_\_\_\_\_

Work Information:

Residential Single Commercial \_\_\_\_\_ Industrial \_\_\_\_\_

New Construction XXXXX Addition \_\_\_\_\_ Remodel \_\_\_\_\_

Accessory Building \_\_\_\_\_ Siding \_\_\_\_\_

(Specific Type)

Brief Description of Work:----- New Single Family Split Level

Size: Length 73 ft. Width 36 No. of Stories Split Level

Area: 1st Floor 648 sq. ft. Basement 792 sq. ft.

2nd Floor 792 sq. ft. Accessory Bldg. 576 sq. ft. garage

3rd Floor \_\_\_\_\_ sq. ft. Other \_\_\_\_\_ sq. ft.

Additional Information: \_\_\_\_\_

APPLICATION FOR PERMIT SHALL BE ACCOMPANIED BY TWO COMPLETE SETS OF PLANS INCLUDING: ELEVATIONS, FLOOR PLANS, CROSS SECTIONS AND PLOT PLAN. IF ADDITION OR REMODELING, SHOW ALL EXISTING STRUCTURES AND THEIR SIZE AND LOCATION. ALL PLANS SHALL BE DRAWN TO SCALE.

Date 7-26-85

Applicant's Signature Ron Zachrich

PERMIT NO. 1067

PERMIT FEE \$ 132.00

PLOT PLAN

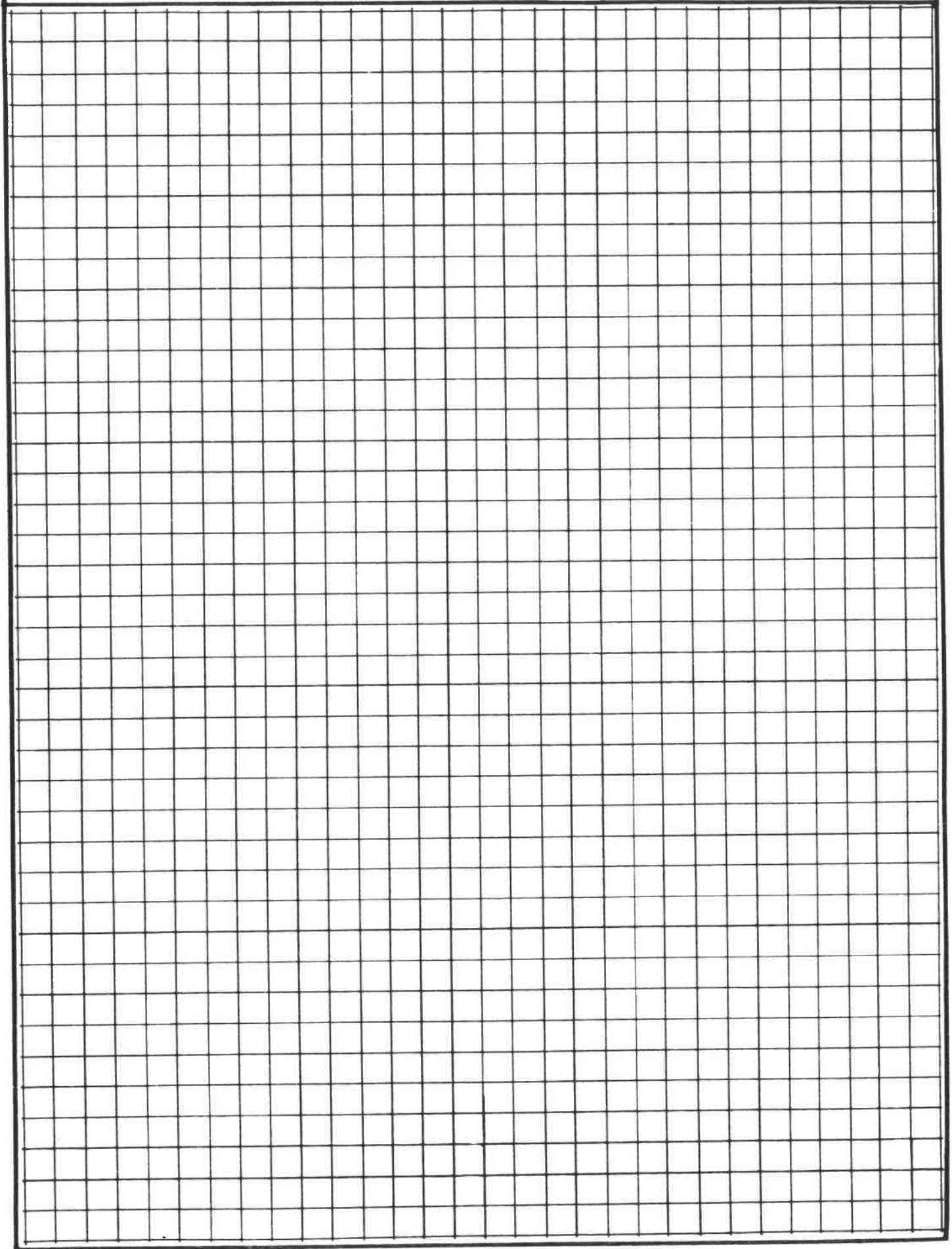



CITY OF NAPOLEON  
BUILDING INSPECTION DEPARTMENT  
APPLICATION FOR ELECTRICAL PERMIT  
(Please print or type)

The undersigned hereby makes application for installation or replacement of electrical equipment as herein specified, agreeing to do all such work in strict accordance with the City of Napoleon's adopted Electrical Codes.

Owner's Name Eugene & Barbara Hogrefe Address 607 E. Riverview

Electrical Contractor Ron Zachrich Telephone No. 762-5277

Address Rt. 2, Napoleon

General Contractor Ron Zachrich Telephone No. \_\_\_\_\_

Address \_\_\_\_\_

Location of Project 1600 Oakwood Cost of Project \_\_\_\_\_

Work Information:

Residential Single Family Commercial \_\_\_\_\_ Industrial \_\_\_\_\_

No. Units

New XXX Service Change \_\_\_\_\_ Rewiring \_\_\_\_\_ Additional Wiring \_\_\_\_\_

Brief Description of Work: New House Wiring

Size of proposed service entrance 200 Amp Number of new circuits 40

Type of proposed service entrance \_\_\_\_\_ Underground \_\_\_\_\_ Overhead X

Require Temporary Electric Yes (Yes or No)

Total Floor Area - Commercial and Industrial only \_\_\_\_\_ sq. ft

Additional Information: \_\_\_\_\_

\*Ground fault circuit interrupter protection is required on all 120-volt single phase, 15 and 20 amp. Circuits which are part of a temporary electric service: and also on bathroom, outdoor, and garage receptacles in all dwelling units. Art. 210-8 N.E.C.

\*Application for permit shall be accompanied by two complete sets of plans including: Electrical layout and riser diagram. (For commercial and industrial work only).

Date 7-26-51 Applicant's Signature Ron Zachrich

PERMIT NO. 1067  
PERMIT FEE \$ 45.00  
10/10 TEMP



CITY OF NAPOLEON  
 BUILDING INSPECTION DEPARTMENT  
 APPLICATION FOR PLUMBING PERMIT  
 (Please print or type)

The undersigned hereby makes application for the installation or replacement of plumbing work as herein specified, agreeing to do all such work in strict accordance with the City of Napoleon's adopted Plumbing Codes. (1, 2 and 3 family dwelling units only).

Owner's Name Eugene & Barbara Hogrefe Address 607 E. Riverview

Plumbing Contractor Meyers Plmb. Telephone No. 592-6771

Address 829 N. Perry

General Contractor Ron Zachrich Telephone No. \_\_\_\_\_

Address \_\_\_\_\_

Location of Project 1600 Oakwood Cost of Project \_\_\_\_\_

Work Information:

No. of dwelling units 1 New \_\_\_\_\_ Replacement \_\_\_\_\_ Addition \_\_\_\_\_

Brief description of work: \_\_\_\_\_

Is water tap required Yes Size 1" Type of Pipe \_\_\_\_\_

Is sewer tap required Yes Size 4" Type of Pipe PVC

Type of Water Distribution pipe \_\_\_\_\_

Type of Drainage, Waste and Vent Pipe PVC

Size of main building drain 3" Size of main vent pipe 3"

Water closets <u>3</u>	Bathtubs <u>1</u>	<u>2"</u>	Shower <u>1</u>	<u>2"</u>
	No.	Trap Size	No.	Trap Size

Lavatories <u>4</u>	<u>1½"</u>	Kitchen Sink <u>1</u>	<u>1½"</u>	Disposal <u>1</u>	<u>1½"</u>
No.	Trap Size	No.	Trap Size	No.	Trap Size

Dishwasher _____	Clothes Washer <u>1</u>	<u>1½"</u>	Other _____
No.	Trap Size	No. Trap Size	No. Trap Size

All installations are subject to plumbing tests and/or inspections.

Date 7-26-55 Applicant's Signature Ron Zachrich

PERMIT NO. 1067-  
 PERMIT FEE \$ 15.00



CITY OF NAPOLEON  
BUILDING INSPECTION DEPARTMENT  
APPLICATION FOR HEATING PERMIT  
(PLEASE PRINT OR TYPE)

The undersigned hereby makes application for the installation, replacement or alteration of a heating system or device as herein specified, agreeing to do all such work in strict accordance with the City of Napoleon's adopted Mechanical Code for 1, 2 and 3 Family Buildings.

Owner's Name Eugene & Barbara Hogrefe Address 607 E. Riverview  
Contractor's Name Meyers Heating Address 829 N. Perry Tel. \_\_\_\_\_

BUILDING INFORMATION:

Single Family XXX Double Family \_\_\_\_\_ Multiple \_\_\_\_\_ New Construction Xxx  
Addition \_\_\_\_\_ Remodel \_\_\_\_\_ Replacement \_\_\_\_\_ No. of Stories \_\_\_\_\_

DESCRIPTION OF WORK

Heating System - Warm Air  Hot Water \_\_\_\_\_ Steam \_\_\_\_\_ Electric \_\_\_\_\_

Unit Heaters \_\_\_\_\_ Unit Gas Heaters  Other \_\_\_\_\_

Type - Gravity \_\_\_\_\_ Forced \_\_\_\_\_ Radiant \_\_\_\_\_

No. of Thermostatical Heating Zone \_\_\_\_\_

Hot Water - One Pipe \_\_\_\_\_ Two Pipe \_\_\_\_\_ Series Loop \_\_\_\_\_

Electric Heat - No. of Circuits \_\_\_\_\_ Other \_\_\_\_\_

Total Heat Loss of Area to be Heated \_\_\_\_\_ Btu.

Rated Capacity of Furnace/Boiler \_\_\_\_\_ Btu.

No. of Furnaces 1 No. of Hot Air Runs 13

No. of Hot Water Radiators \_\_\_\_\_ Type of Fuel \_\_\_\_\_

Heating Units Located: Crawl Space \_\_\_\_\_ Floor Level \_\_\_\_\_ Suspended \_\_\_\_\_

Roof or Exposed to Outside Air \_\_\_\_\_ Attic \_\_\_\_\_ Other \_\_\_\_\_

APPLICATION FOR PERMIT SHALL BE ACCOMPANIED BY TWO COMPLETE SETS OF PLANS INCLUDING: LOCATION OF FURNACE OR UNIT HEATERS AND SIZE AND LOCATION OF FEEDER DUCTS AND RETURN AIR DUCTS. ALL PLANS SHALL BE DRAWN TO SCALE.

ESTIMATED COST OF COMPLETED PROJECT: Incl of general

DATE 7-26-85 APPLICANT'S SIGNATURE Row Jactuly

OWNER-CONTRACTOR-AGENT

1067

15-75



# PROJECT RECORD FORM

JOB NUMBER \_\_\_\_\_

DATE	REMARKS
19 DEC 85 2:30 PM	FINAL INSPECTION
11	ELECTRIC PRIMARY SMOKE DETECTORS R-216.2 CABO
	HAND RAIL ON EAST STEPS R-215.1 CABO
	FUSE SMOKE DETECTOR CIRCUIT NEC
	CORRECT WIRING ON FURNACE NEC
	RE-INSPECTION TO BE MADE 11:00 AM FRI 20 DEC 85
20 DEC 85 10:00 AM	TEMPORARY COO NO. 424 SMOKE DETECTORS ELECTRICAL COVER PLATES

PALM BLEIBER  
Rene SONNENBERG





APPLICATION FOR PERMIT TO TAP SEWER

Eugene & Barbara Hogrefe

NO. \_\_\_\_\_

ADDRESS 607 E. Riverview

BLDG. PERMIT 1067

CONTRACTOR Ron Zachrich

PERMIT FEE \$ 60.00

ADDRESS Rt. 2, Napoleon TEL. 762-5277

STREET BOND \_\_\_\_\_

DATE PAID \_\_\_\_\_

For office use only

LOCATION OF CONNECTION

Street and No. 1600 Oakwood Sanitary XXXX Storm \_\_\_\_\_

Lot No. \_\_\_\_\_ Subdivision \_\_\_\_\_ Size of Tap 4"

Size and Type of Sewer 4" PVC ALL WORK MUST BE INSPECTED

Street to be opened-Yes \_\_\_\_\_ No \_\_\_\_\_ Opening bond fee set by Engineer \$ \_\_\_\_\_

Street opening agreement approval date \_\_\_\_\_

I certify that the sewer will be used only as indicated and no other drainage to be connected.

Date \_\_\_\_\_ Signature *Ron Zachrich* Owner-Builder-Agent

DO NOT WRITE BELOW THIS LINE

INSPECTION RECORD

Date Inspected \_\_\_\_\_ Size and Type of Sewer \_\_\_\_\_

Location \_\_\_\_\_ Depth \_\_\_\_\_ Type of Test \_\_\_\_\_

Inspected and Approved by: \_\_\_\_\_ Inspector \_\_\_\_\_ Date \_\_\_\_\_

Additional information \_\_\_\_\_

Send copy to: \_\_\_\_\_

SKETCH OF INSTALLATION -ON BACK

PAID

JUL 30 1985

CITY OF NAPOLEON

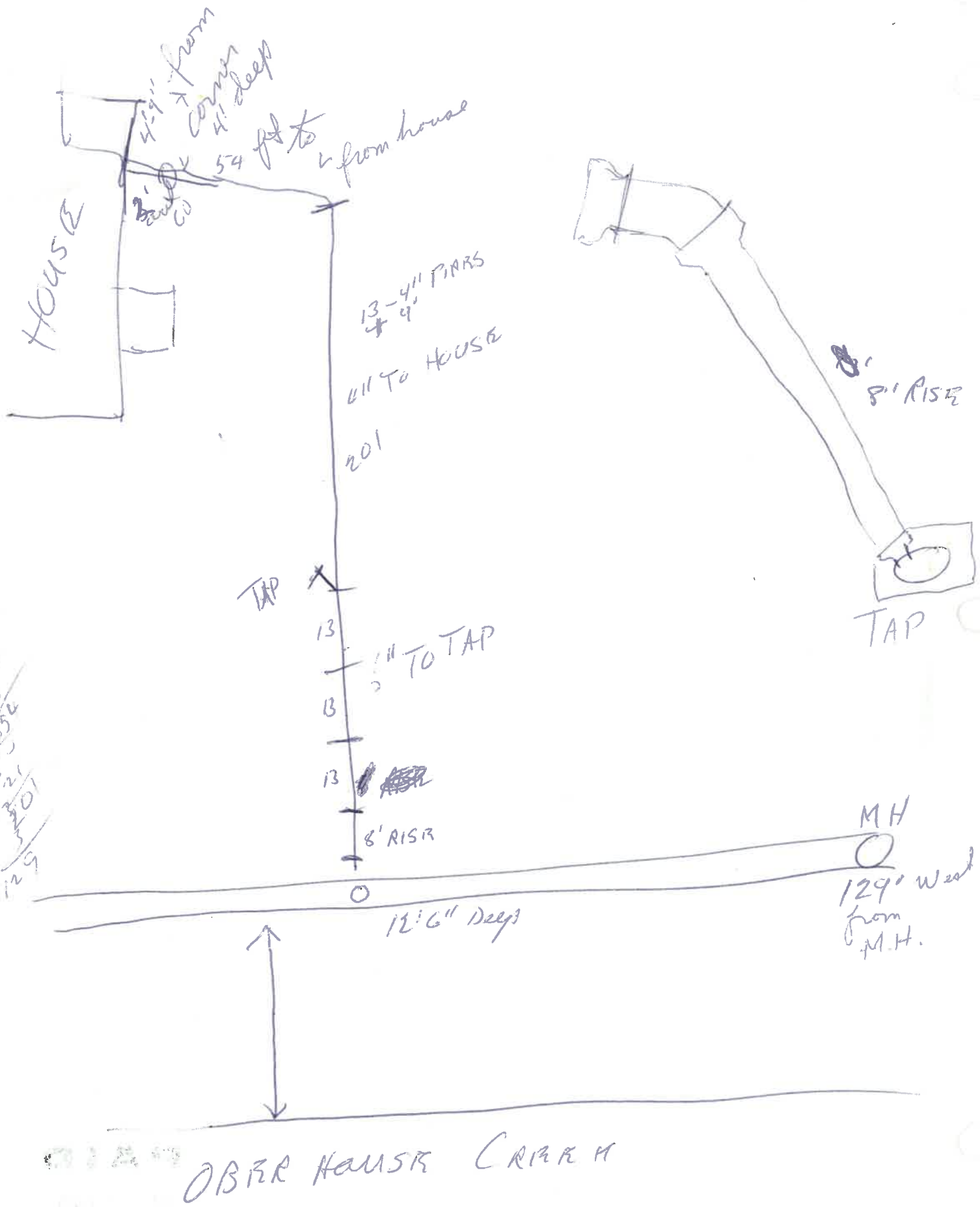

$$\begin{array}{r} 129 \\ 129 \\ \hline 0 \\ 129 \\ \hline 129 \end{array}$$

# PERMIT

**CITY OF NAPOLEON - BUILDING DEPARTMENT**  
 255 West Riverview Avenue, Napoleon, Ohio 43545 - 419-592-4010

Permit No. 01067 Issued July 26, 1985  
date

Job Location 1600 Oakwood  
address

Lot \_\_\_\_\_  
sub-div or legal discript

Issued By Richard G. Hayman  
building official

Owner Eugene & Barbara Hogrefe 592-2831  
name tel.

Address 607 E. Riverview

Agent Ron Zachrich 762-5277  
builder-eng.-etc. tel.

Address Rt. 2, Napoleon

Description of Use New Single Family /with  
attached garage

Residential Single  
no. dwelling units

Commercial \_\_\_\_\_ Industrial \_\_\_\_\_

New \_\_\_\_\_ Add'n. \_\_\_\_\_ Alter \_\_\_\_\_ Remodel \_\_\_\_\_

Mixed Occupancy \_\_\_\_\_

Change of Occupancy \_\_\_\_\_

Estimated Cost \$ 82,000 <sup>00</sup>/<sub>100</sub>

FEES	BASE	PLUS	TOTAL
BUILDING			132.00
ELECTRICAL	5.00	40.00	45.00
PLUMBING	3.00	12.00	15.00
MECHANICAL	6.00	<del>1.75</del> 3.00	<del>15.75</del> 9.00
DEMOLITION			
ZONING			
SIGN			
WATER TAP	300.00		300.00
SEWER TAP	<del>60.00</del>		<del>60.00</del>
TEMP. ELECT.	10.00		10.00
ADDITIONAL PLAN REVIEW	Struct. _____ hrs	Elect. _____ hrs	
TOTAL FEES			511.00 <del>511.00</del>
LESS MIN. FEES PAID			-0-
BALANCE DUE		date	511.00 <del>511.00</del>

### ZONING INFORMATION

district	lot dimensions	area	front, yd	side yds	rear yd
B	546 X 406	221,676			
max hgt	no pkg spaces	no ldg spaces	max cover	petition or appeal req'd	date appr

### WORK INFORMATION:

Size: Length 73 ft. Width 36 ft. Stories Split Ground Floor Area \_\_\_\_\_

Height \_\_\_\_\_ Building Volume (for demo. permit) \_\_\_\_\_ cu. ft.

Electrical: \_\_\_\_\_  
brief description

Plumbing: \_\_\_\_\_  
brief description

Mechanical: \_\_\_\_\_  
brief description

Sign: \_\_\_\_\_ type \_\_\_\_\_ Dimensions \_\_\_\_\_ Sign Area \_\_\_\_\_

Additional Information: \_\_\_\_\_

**PAID**  
 JUL 30 1985  
 CITY OF NAPOLEON

Date \_\_\_\_\_ Applicant Signature Ron Zachrich  
owner-agent

# INSPECTION RECORD

	UNDERGROUND			ROUGH-IN						FINAL		
	Type	Date	By	Type	Date	By	Type	Date	By	Type	Date	
<b>PLUMBING</b>	Building Drains			Drainage, Waste & Vent Piping	10/1/85	RJA	Indirect Waste			Drainage, Waste & Vent Piping	10/1/85	
	Water Piping									Backflow Prevention		
	Building Sewer	10/1/85	RJA	Water Piping			Condensate Lines			Water Heater		
	Water Line	3/85	RJA									
	Sewer Connection									FINAL APPROVAL		
<b>MECHANICAL</b>	Refrigerant Piping			Refrigerant Piping			Chimney(s)			Grease Exhaust System		
				Duct Furnace(s)			Fire Dampers			Air Cond. Unit(s)		
	Ducts/Plenums			Ducts/Plenums			<input type="checkbox"/> Radiant Htr(s) <input type="checkbox"/> Unit Htr(s)			Refrigeration Equipment		
				Duct Insulation			Pool Heater			Furnace(s)		
				Combustion Products Vents			Ventilation <input type="checkbox"/> Supply <input type="checkbox"/> Exhst.			FINAL APPROVAL		
<b>ELECTRICAL</b>	Conduits & or Cable			Conduits/Cable			<input type="checkbox"/> Range <input checked="" type="checkbox"/> Dryer	19 DEC 85	PEB	Temp Service Temp Lighting		
	Grounding & or Bonding	19 DEC 85	PEB	Rough Wiring	11/10/85	RJA	<input type="checkbox"/> Generator(s) <input type="checkbox"/> Motors			Fixtures Lampholders		
	Floor Ducts Raceways			Service Panel Switchboard	10/1/85	RJA	<input type="checkbox"/> Water Htr <input type="checkbox"/> Welder			Signs SMOKE DETECTORS		
	Service Conduit			Busways Ducts			<input type="checkbox"/> Heaters <input type="checkbox"/> Heat Cable			Electric Mtr. Clearance	10/1/85	
	Temporary Power Pole			Subpanels			<input type="checkbox"/> Duct Htr(s) <input checked="" type="checkbox"/> Furnace(s)	29 DEC 85	PEB	FINAL APPROVAL	23 MAY 86 PEB	
<b>BUILDING</b>	Location, Set-backs, Esmt(s)			Exterior Wall Construction	9/16/85	RJA	Roof Covering Roof Drainage	9/16/85	RJA	Smoke Detector		
	Excavation			Excavation	10/1/85	RJA	Exterior Lath			Demolition (sewer cap)		
	Footings & Reinforcing	8/1/85	RJA				<input type="checkbox"/> Interior Lath <input type="checkbox"/> Wallboard					
	Floor Slab			Interior Wall Construction			Fire Wall(s)			Building or Structure	12/20/85 PEB	
	Foundation Walls	9/1/85	RJA	Columns & Supports			Fireplace Chimney					
	Sub-soil Drain			Crawl Space <input type="checkbox"/> Vent <input type="checkbox"/> Access			Attic <input type="checkbox"/> Vent <input type="checkbox"/> Access	12/20/85	PEB			
	Piles			Floor System(s)	9/16/85	RJA				FINAL APPROVAL BLDG. DEPT.		
				Roof System	9/16/85	RJA	Special Insp Reports Rec'd			Certificate of Occupancy Issued		
<b>ADDITIONAL</b>	<b>INSPECTIONS, CORRECTIONS, ETC.</b>						<b>INSPECTIONS, CORRECTIONS, ETC.</b>					
	3/1/84 Basement bot lock. RJA											
	11 DEC 85 REQUIREMENT FOR FURNACE GAS RANGE & DRYER CHAULT											

No. 427.....

CERTIFICATE OF OCCUPANCY  
THE CITY OF NAPOLEON

ENGINEERING DEPARTMENT  
DIVISION OF INSPECTION

This is to certify that the Building or Land as herein described complies with all the building and health laws and ordinances and with the provisions of the Zoning Ordinance.

Location of Occupancy 1600 Oakwood Avenue ..... Occupancy Single family residence  
Owner of Property Eugene & Barbara Hogrefe ..... Address 1600 Oakwood Ave.  
Issued to Eugene & Barbara Hogrefe ..... Address 1600 Oakwood Ave.  
Zoning "B" Residence ..... Bldg. Permit No. 1067  
Substantial qualifications of occupancy .....

This certificate is issued by the City Building Inspector, as provided by law, and is to certify that construction is completed substantially in conformity with the approved plans and permission is hereby granted to occupy such building in compliance with such legal use and occupancy as authorized under the provisions of the ordinances of the City of Napoleon.

Issued this 13th ..... day of June ..... 1986.

This is a valuable record for owner or lessee and should be so preserved.

Signed *Ronald D. Samerberg*  
City Building Inspector

